

PRODUCT SPECIFICATIONS



Publication Date:
November, 2017

Description:
Hino Dutro SmartBar

Application:
Hino Dutro 5000, 5500 (1995-12/04) models, refer last page for fitment information

Fitting:
Minimum 3 Hours

Available:
Now

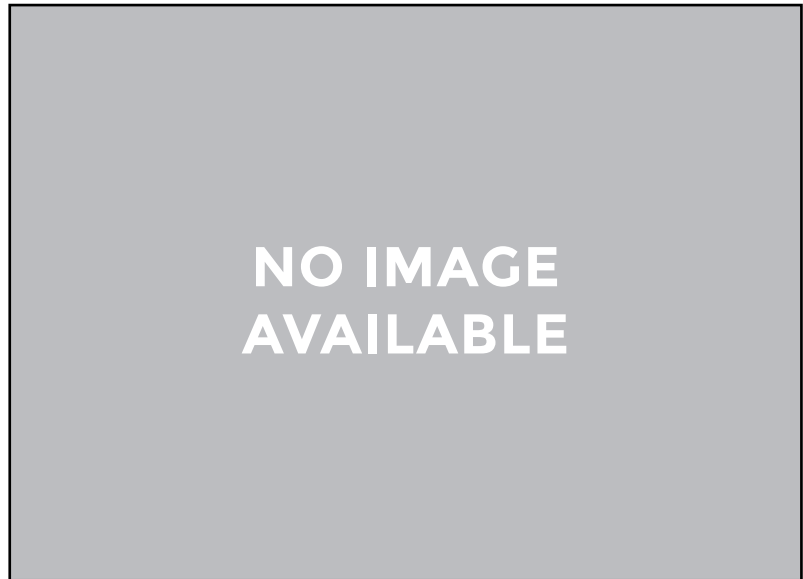

Product Specification

Specifically designed for the Hino Dutro as a full bumper replacement, the latest model of SmartBar's Vehicle Frontal Protection System (VFPS) complements the design and shape of the vehicle, whilst maintaining the contour lines and aesthetics. The SmartBar maintains all of the factory accessories and all the while provides unparalleled safety.

Designed to suit the 5000 and 5500 (1995-12/04) in all body types, the SmartBar is engineered to be the lightest and safest VFPS available; offering even more protection and safety for Dutro owners and now importantly, pedestrians.

Please note that the white colour is no longer available, black is available as standard with other colour options only for large quantity orders.

SmartBar, a lighter, safer, and greener alternative to impact resistant bull and nudge bars.

Protection & Styling Characteristics:

- Meets full Australian Standard AS 4876.1-2002. Including 3.2 Road User Protection
- Weight savings provide improved fuel economy and reduced tyre, suspension and brake wear when compared to other alternatives
- Total Bar Weight of **42kg**
- Air Bag Compatible
- Bumper replacement, easily fitted
- Superior frontal protection, due to the impact absorbing hollow construction
- Supplied with durable Indicator/Parker Lights
- Supplied with 1 x Aerial Mount Bracket
- Does not accept original vehicle fog lamps
- UV stabilised polymer for durability and corrosion resistance
- Styled to maintain the Vehicle's aesthetic
- Proudly designed and manufactured in Australia
- Minimal maintenance
- Minimal repair costs after impact
- Manufactured from environmentally friendly, recyclable polyethylene polymer
- Available in Black as standard, other colours available for large order quantities
- SmartBar is tested to ensure a HIC (Head Injury Criteria) figure below the Australian Standard rating of 1500, as to provide pedestrians with a higher probability of surviving a low speed impact

Chassis Mounts:

The chassis mount design comprises of a two part construction which allows for three axis adjustability, to achieve a solid and perfect fit every time.

All brackets have been tested and comply with Vehicle Air Bag, Winch Maximum Pull Exertion and Australian Safety Standards.

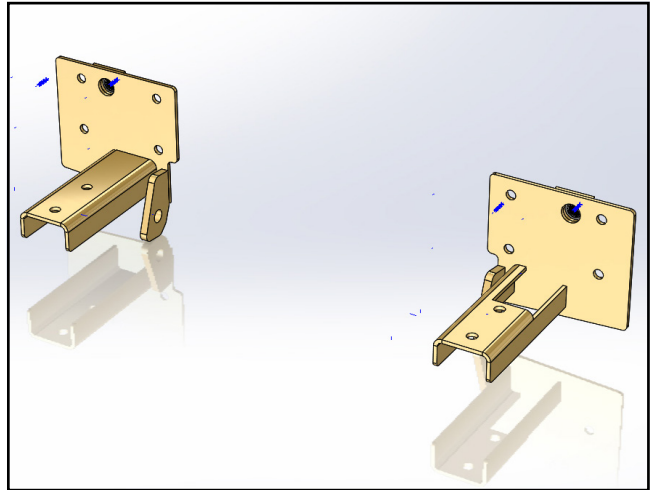

Pedestrian Safety:

SmartBar's have been tested and proven to be less likely to cause serious injury to pedestrians than other alternatives. This is due to the hollow construction which allows the bar to absorb most of the impact along with the unique and specifically designed co-polymer material.

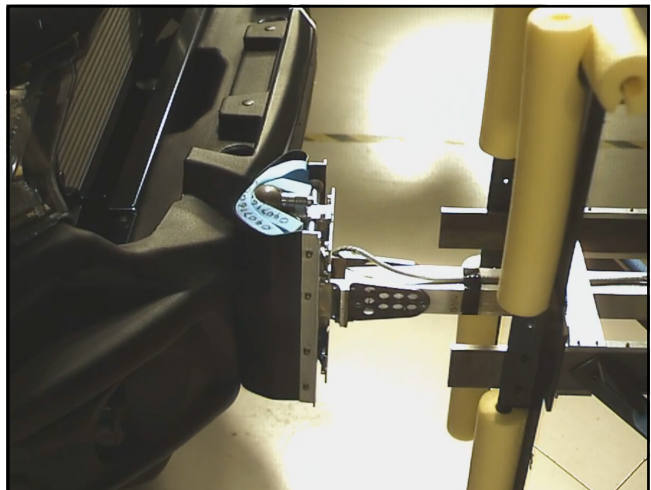

Indicators:

The SmartBar is supplied with a pair of high quality indicators/parkers as standard. Spare lenses are also available for purchase in the event of a replacement.

Indicator/Parker Part Number:
BP1173

Replacement Lens:
BP1174



PART NUMBER MATRIX



SMARTBAR HINO DUTRO (1995-12/04)

SmartBar

Fitting Time

3 Hours

Vehicle

Model
(Guide Only)

Hino Dutro ¹

5000 & 5500

SA010BL095

Please note:

¹ SmartBar is available only made to order