

# PRODUCT SPECIFICATIONS



**Date:**

August, 2018

**Description:**

Mercedes Sprinter SmartBar

**Application:**

Mercedes Sprinter (10/06-09/13)

**Fitting:**

Minimum 3 Hours (Non Winch)

**Available From:**

Now

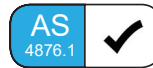

## Product Specification

Specifically designed for the Sprinter (10/06-09/13) as a full bumper replacement this model of SmartBar's Vehicle Frontal Protection System (VFPS) perfectly complements the design and shape of the vehicle.

The SmartBar maintains most of the factory accessories (doesn't accept fog lights) and all the while providing unparalleled safety.

Designed to suit the entire Sprinter range, the SmartBar is engineered to be the lightest bull bar available; offering even more protection and safety for Sprinter owners and pedestrians.

## Protection & Styling Characteristics:

- Meets full Australian Standard AS 4876.1-2002. Including 3.2 Road User Protection
- Weight savings provide improved fuel economy and reduced tyre, suspension and brake wear when compared to other alternatives
- Fitted Weight of **36kg**
- Fitted Weight of **37kg (Ambulance)**
- Full Bumper replacement, easily fitted
- Air Bag Compatible
- SmartBar adds approximately 150mm to overall length of the vehicle
- Superior frontal protection, due to the impact absorbing hollow construction
- UV stabilised polymer for durability and corrosion resistance
- Proudly designed and manufactured in Australia
- Durable LED Parker/Indicator Lights
- Supplied with 1 x Antenna Mount
- Antenna mount locations are found behind the loops of the bar, up to 2 available
- Styled to maintain the Vehicle's aesthetic
- Minimal maintenance
- Minimal repair costs after impact
- Manufactured from environmentally friendly, recyclable polyethylene polymer
- Available in Black as standard, other colours available for large order quantities
- Accommodates a large range of spotlights
- SmartBar is tested to ensure a HIC (Head Injury Criteria) figure below the Australian Standard rating of 1500, as to provide pedestrians with a higher probability of surviving a low speed impact

## Chassis Mounts:

The chassis mount design for the Mercedes Sprinter SmartBar comprises of a two part construction which allows for two axis adjustability, to achieve a solid and perfect fit every time.

All brackets have been tested and comply with Vehicle Air Bag and Australian Safety Standards.

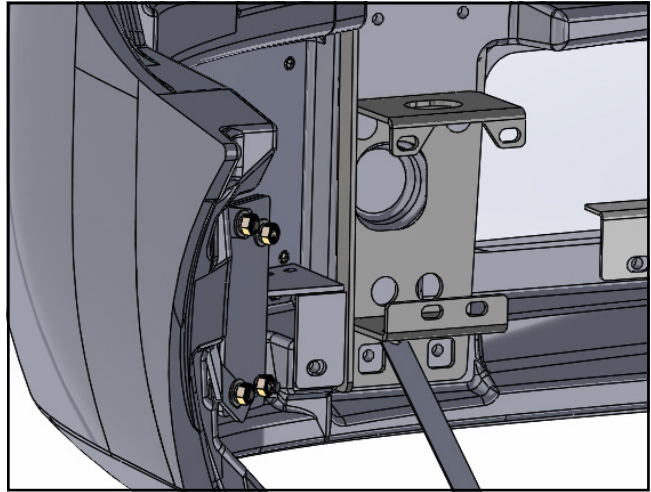

## Pedestrian Safety:

SmartBar's have been tested and proven to be less likely to cause serious injury to pedestrians than other alternatives. This is due to the hollow construction which allows the bar to absorb most of the impact along with the unique and specifically designed co-polymer material.

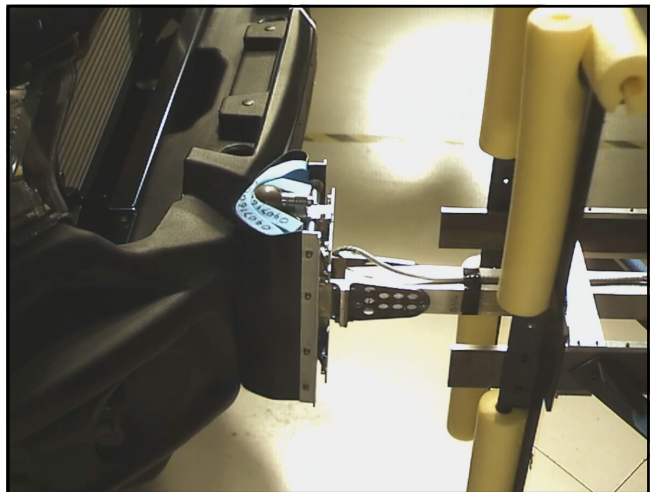

## Antenna Mounts:

There is an antenna mount incorporated onto the top loop of the bull bar on both sides of the vehicle. The SmartBar is supplied with a single antenna mount and can be mounted facing forward and backward depending on application (000-AMB11). Additional antenna mounts can be purchased:

000-AMB11 (TP44782 Aerial Mount Kit)

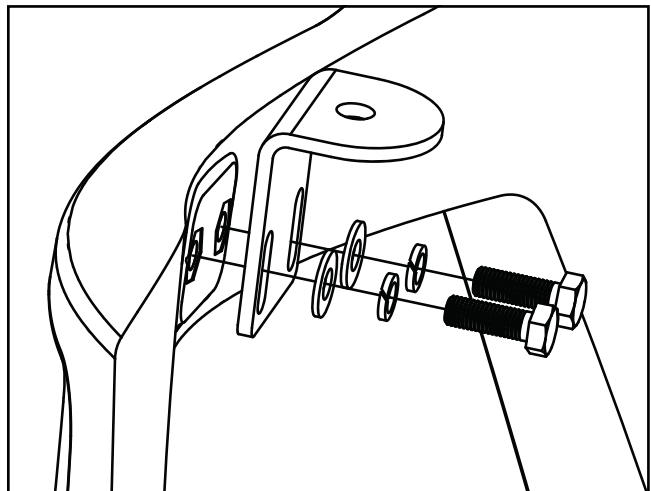

## LED Parker/Indicator Lights:

A durable LED Parker/Indicator is supplied with the bar (BP50035/BP50042), as shown here with the parker illuminated.

Please note that the lights shown here are the old version (BP38538) that has been since replaced. It has a milky white lens and a regular globe, please check light before ordering replacements.

Please note that the flasher light is not included with the SmartBar.



## Driving Light Mounts:

The SmartBar is supplied with an accessory bracket to mount driving lights, light bars and other accessories.



## Full Bumper Replacement:

The SmartBar is a full bumper replacement which is specifically designed to maintain the aesthetic of the Mercedes Sprinter.





## Light Model Fitment:

The SmartBar for the Mercedes Sprinter models accommodates the following Lights:

### ARB Intensity:

- ARB Intensity 21
- ARB Intensity 32
- ARB Intensity Light Bar AR40 (requires pedestal mount)

### Bushranger Night Hawk:

- NHP180 (S&D) (180mm Round LED light)
- NHS055-NHS245 (5.5 inch to 24.5 inch light bars)

### IPF:

- 801/901 Xtreme Sport Series
- 800/900 HID Series
- 800/900 Series
- 900 Xtreme LED Sport Series



# PART NUMBER MATRIX

## SMARTBAR MERCEDES SPRINTER (10/06 - 09/13)

SmartBar  
Non Winch

Fitting Time

3 Hours

**Mercedes Sprinter**

Model  
(Guide Only)

Panel Van, Minibus, Single & Dual Cab  
Chassis <sup>1</sup>

Panel Van, Mini Bus,  
Single and Double Cab  
Chassis

SA116BL116

Ambulance Spec <sup>1</sup>

Panel Van, Mini Bus,  
Single and Double Cab  
Chassis

SA116BL000

Please note:

<sup>1</sup> Not compatible with OEM Fog Lights