

# PRODUCT SPECIFICATIONS

**Publication Date:**

August, 2018

**Description:**

Pajero NX SmartBar

**Application:**

Mitsubishi Pajero NX 9/14+

**Fitting:**

Minimum 3.5 Hours

(Non Winch)

Minimum 4.5 Hours

(Winch)

**Available:**

Now



**PROUDLY  
AUSTRALIAN MADE**

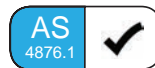

## Product Specification

Specifically designed for the 09/2014+ Pajero NX as a bumper trim, SmartBar's Vehicle Frontal Protection System (VFPS) perfectly complements the design and shape of the vehicle, maintains all of the factory accessories and all the while provides unparalleled safety.

Designed to suit the GLS, GLX and Exceed, the SmartBar is engineered to be the lightest and safest VFPS available; offering even more protection and safety for Pajero owners and importantly, pedestrians.

## Protection & Styling Characteristics:

- Meets full Australian Standard AS 4876.1-2002. Including 3.2 Road User Protection
- Weight savings provide improved fuel economy and reduced tyre, suspension and brake wear when compared to other alternatives
- Fitted Weight of **33kg for Non Winch**
- Fitted Weight of **46kg for Winch**
- Air Bag Compatible
- Bumper trim, easily fitted
- Superior frontal protection, due to the impact absorbing hollow construction
- Not compatible with the original vehicle fog lights or DRL's from bumper
- Supplied with durable LED Parker/Indicator Lights
- Optional 100mm driving light kit available<sup>1</sup>
- Optional 100mm fog light kit available<sup>1</sup>
- Optional day time running light kit available<sup>1</sup>
- Supplied with head light washer kit
- Supplied with 2 x Antenna Mounts
- Antenna mount location on loops of the bar, up to 4 available
- UV stabilised polymer for durability and corrosion resistance
- Styled to maintain the Vehicle's aesthetics
- Proudly designed and manufactured in Australia
- Minimal maintenance
- Minimal repair costs after impact
- Manufactured from environmentally friendly, recyclable polyethylene polymer
- Available in Black as standard, other colours available for large order quantities
- Accommodates a large range of spotlights
- Winch compatible bar accommodates up to 9,000lb Winch
- SmartBar is tested to ensure a HIC (Head Injury Criteria) figure below the Australian Standard rating of 1500, as to provide pedestrians with a higher probability of surviving a low speed impact

<sup>1</sup> SmartBar can only accommodate one option

## Chassis Mounts:

The chassis mount design for the Pajero NX SmartBar comprises of a two part construction which allows for three axis adjustability, to achieve a solid and perfect fit every time.

All brackets have been tested and comply with Vehicle Air Bag, Winch Maximum Pull Exertion and Australian Safety Standards.

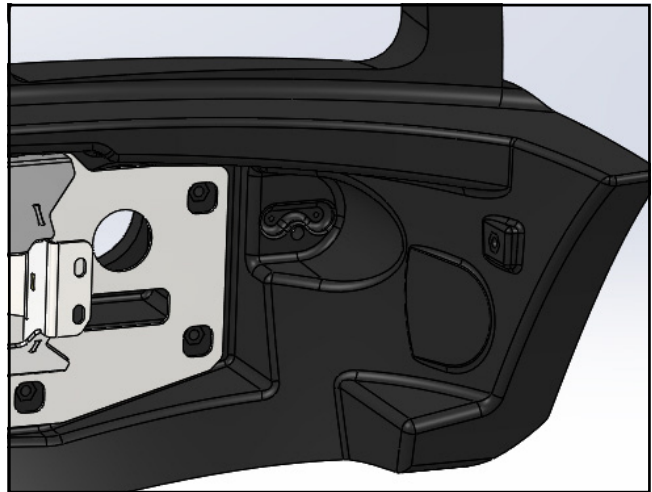

## Pedestrian Safety:

SmartBar's have been tested and proven to be less likely to cause serious injury to pedestrians than other alternatives. This is due to the hollow construction which allows the bar to absorb most of the impact along with the unique and specifically designed co-polymer material.



## Winch Mount:

The SmartBar winch bracket kit is winch compatible for winches up to 9,000lb. See overleaf for full winch details.



## Light Mounts:

The SmartBar is supplied with an accessory bracket to mount driving lights, light bars and other accessories.

To see further details on light fitment see page overleaf.



## Optional Day Time Running Lights:

The SmartBar design can incorporate a high quality Narva Day Time Running Light (DRL) to provide additional safety when driving during daylight hours. The DRL is designed to turn on with the vehicle ignition and off when the vehicle parker lights are turned on. Kit number available for purchase 000-DRLK.



## Optional 100mm Driving Light/ Fog Light:

The original fog lights from the Pajero bumper aren't compatible with the SmartBar.

There is also a Narva Driving Light and a Narva Fog light that can be purchased and installed in the infill area inboard of the indicator/parker lights. Only one option can be accommodated though, refer to matrix fitment overleaf for details.





## Antenna Mounts:

There are antenna mounts incorporated onto the top loops of the bull bar. The SmartBar is supplied with two antenna mounts. Additional antenna mounts can be purchased:

Horizontal Mount: MM24937

Vertical Mount: MM26504

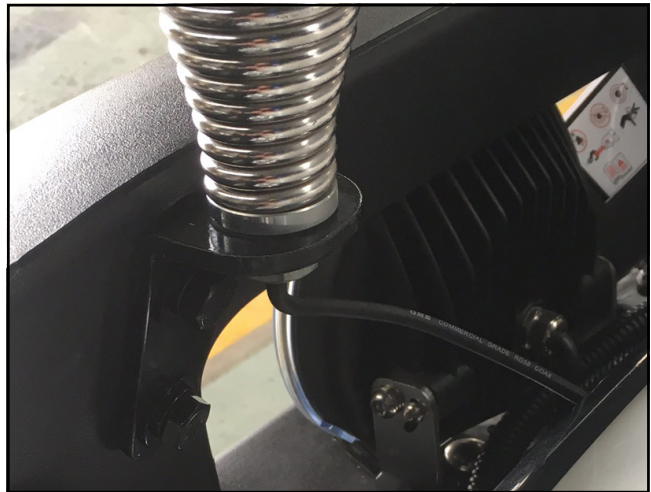

## Headlight Washer Kit:

Supplied as standard with the SmartBar and features in the bar as shown here.

These are a legal requirement for vehicles with HID head lights.



## LED Parker/Indicator:

The SmartBar is supplied with a durable LED parker indicator as standard; the part numbers are BP50035 for the left hand and BP50042 for the right hand.



## Winch Model Fitment:

The SmartBar winch compatible bracket kit accommodates the following winches:

- Warn XD9000

The SmartBar is supplied with an accessory bracket that mounts to the bar in front of the grille. The winch control box can be mounted on the accessory bracket between the spotlights.

Fitment of the control box to the accessory bracket will restrict the size of the lights that can be mounted. Light bars will not fit on accessory bracket at all in this instance.

A flip up number plate bracket is recommended for standard size number plates when SmartBars are fitted with a winch, ARB Part number 3500630.



## Light Model Fitment:

The SmartBar accommodates the following Lights:

ARB Intensity:

- ARB Intensity 21
- ARB Intensity AR40

Bushranger Night Hawk lights:

- NHP180 (S&D) (180mm Round LED light)
- NHS055 - NHS205 (5.5 inch to 20.5 inch light bars)

IPF Lights:

- 801/901 Xtreme Sport Series
- 800/900 HID Series
- 800/900 Series
- 900 Xtreme LED Sport Series
- 868/968 Series
- 930 Super Rally

NOTE: If a control box is fitted to the Driving Light Mount Bracket, the lights available to be fitted in the SmartBar will be heavily restricted; and it prevents completely the use of any Light Bar.



# PART NUMBER MATRIX



## SMARTBAR MITSUBISHI PAJERO NX 09/14+

Fitting Times	3.5 Hours	4.5 Mins	30 Mins	15 Mins	15 Mins
Vehicle	SmartBar non winch	SmartBar winch	Optional Day Time Running Light Kit <sup>2</sup>	Optional Driving Light Kit <sup>2,3</sup>	Optional Fog Light Kit <sup>2,3</sup>
Model (Guide Only)					
Pajero NX	SA162BL162	SA162BL163	000-DRLK <sup>2</sup>	TP4878 <sup>2,3</sup>	TP23923 <sup>2,3</sup>

Please note:

<sup>1</sup> The OEM Fog lights and Day Time Running lights from the bumper (where applicable) are not compatible with the SmartBar

<sup>2</sup> Bar can only accomodate one option

<sup>3</sup> Supplied with brackets, but no loom