

# PRODUCT SPECIFICATIONS

**Publication Date:**

August, 2018

**Description:**

SmartBar Nissan Navara

**Application:**

Navara NP300, 04/15-2020

**Fitting:**

Minimum 3 Hours (Non Winch)

Minimum 4 Hours (Winch)

**Available:**

Now

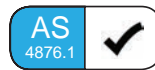

## Product Specification

In early 2015 Nissan released their new Navara model variant's. The Navara is offered in either a wide or narrow body design. The team at SmartBar has now finished development on a new frontal protection system styled to accommodate them all.

Specifically designed for the 04/2015-2020 Nissan Navara as a partial bumper replacement, SmartBar's Vehicle Frontal Protection System (VFPS) perfectly complements the design and shape of the vehicle, maintains most of the factory accessories and all the while provides unparalleled safety.

Designed to suit the SL, ST, ST-X, DX and RX models, the SmartBar is engineered to be the lightest and safest bumper replacement VFPS available; offering even more protection and safety for Navara owners and importantly, pedestrians.

## Protection & Styling Characteristics:

- Meets full Australian Standard AS 4876.1-2002. Including 3.2 Road User Protection
- Weight savings provide improved fuel economy and reduced tyre, suspension and brake wear when compared to other alternatives
- Fitted Weight of **36kg for Non Winch**
- Fitted Weight of **40kg for Winch**
- Increases the length of the Vehicle by 180mm
- SmartBar centre line approach angle is 30 degrees
- Air Bag Compatible
- Bumper trim, easily fitted
- Superior frontal protection, due to the impact absorbing hollow construction
- Accepts the original vehicle fog lights
- Supplied with durable Day Time Running Lights (SL, ST, ST-X models only)
- Durable LED/Parker Indicator Lights
- Supplied with 1 x Antenna Mount
- Antenna mount locations are found behind the loops of the bar, up to 4 available
- UV stabilised polymer for durability and corrosion resistance
- Styled to maintain the Vehicle's aesthetics
- Proudly designed and manufactured in Australia
- Minimal maintenance
- Minimal repair costs after impact
- Manufactured from environmentally friendly, recyclable polyethylene polymer
- Available in Black as standard, other colours available for large order quantities
- Accommodates a large range of spotlights
- Accommodates up to 10,000lb Winch
- Compatible with ARB Under Vehicle Protection
- Not compatible with ARB Recovery Points
- SmartBar is tested to ensure a HIC (Head Injury Criteria) figure below the Australian Standard rating of 1500, as to provide pedestrians with a higher probability of surviving a low speed impact

## Chassis Mounts:

The chassis mount design comprises of a two part construction which allows for three axis adjustability, to achieve a solid and perfect fit every time.

All brackets have been tested and comply with Vehicle Air Bag, Winch Maximum Pull Exertion and Australian Safety Standards.

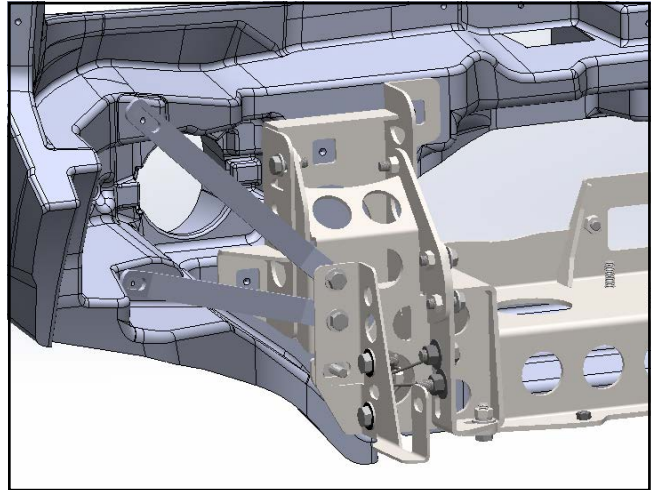

## Pedestrian Safety:

SmartBar's have been tested and proven to be less likely to cause serious injury to pedestrians than other alternatives. This is due to the hollow construction which allows the bar to absorb most of the impact along with the unique and specifically designed co-polymer material.

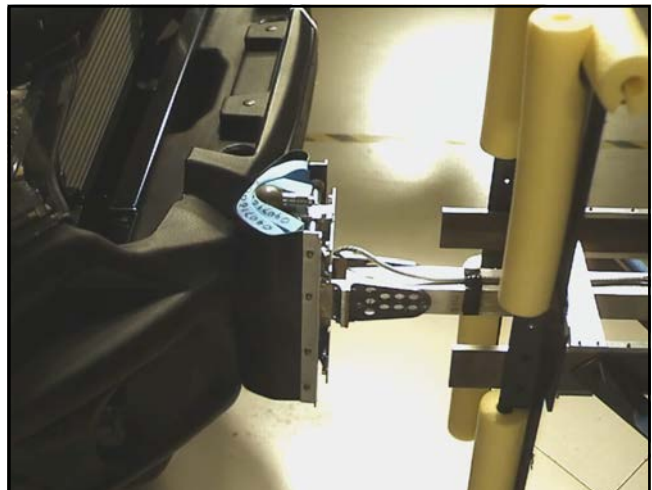

## Fog Lights:

The original Navara fog lights are compatible with the SmartBar.



## Under Vehicle Protection:

The SmartBar in both winch and non winch configurations, is compatible with the ARB Under Vehicle Protection (UVP).



## Day Time Running Lights:

The SmartBar design incorporates high quality Hella Day Time Running Lights (DRL) to provide additional safety when driving during daylight hours. The DRL is designed to turn on with the vehicle ignition and off when the vehicle parker lights are turned on.

DRL's are supplied as standard for the SL, ST and ST-X model variant SmartBar, and are an optional accessory for other models. Please note that a maximum of 2 DRLs are permitted as per ADR requirement.



## Winch Mount:

The SmartBar winch bracket kit is winch compatible for winches up to 10,000lb. See overleaf for full winch details.



## Antenna Mounts:

There are antenna mounts incorporated on the top loops of the bull bar. The SmartBar is supplied with a single antenna mount. Additional antenna mounts can be purchased:

Vertical Mount: TP44928 (supplied)  
Horizontal Mount: TP44799 (optional extra)

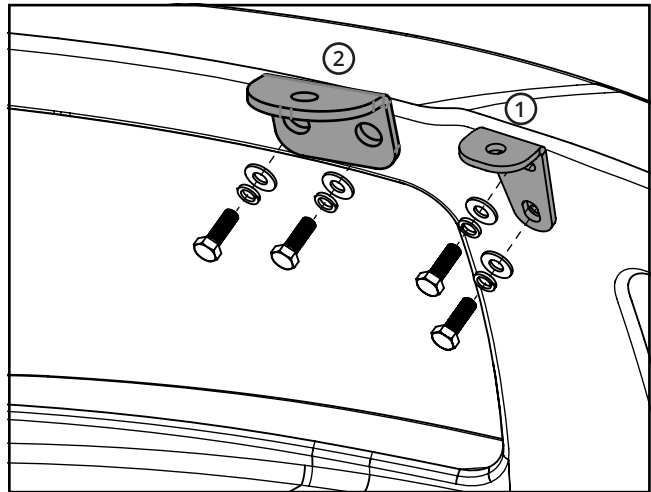

## Driving Light Mounts:

The SmartBar is supplied with an accessory bracket to mount driving lights, light bars and other accessories.

The mount includes pinning holes for the Intensity lights.

To see further details on light fitment see overleaf.





## Winch Model Fitment:

The SmartBar winch compatible bracket kit accommodates the following winches:

- Warn M8000, XD9000, XP9.5 and XDC 9.5
- Warn ZEON 8, 8-S, 10, 10-S
- Warn ZEON Platinum 10, 10-S
- Warn Magnum 8, 10
- Bushranger DV-9TH, DS9.5TH and Seal 9.5TH

The SmartBar is supplied with an accessory bracket that mounts to the bar in front of the grille. The winch control box can be mounted on the accessory bracket between the spotlights.

Additional fit kits are required depending on the winch being fitted:

- Warn Zeon and Zeon Platinum fitment requires the Warn Part number W89965 Short wiring kit. This kit allows relocation of the control box to the accessory bracket.
- A flip up number plate bracket is recommended for standard size number plates when SmartBars are fitted with a winch, ARB Part number 3500630.
- Warn ZEON Platinum fitment may require part No. W94288 Enhanced Signal Kit.



## Light Model Fitment:

The SmartBar accommodates the following Lights:

### ARB Intensity:

- ARB Intensity 21
- ARB Intensity Light Bar AR40 (requires pedestal mount)

### Bushranger Night Hawk lights:

- NHP180 (S&D) (180mm Round LED light)
- NHS055-NHS245 (5.5 inch to 24.5 inch light bars)

### IPF Lights:

- 801/901 Xtreme Sport Series
- 800/900 HID Series
- 800/900 Series
- 900 Xtreme LED Sport Series
- 868/968 Series
- 930 Super Rally

NOTE: If a control box is fitted to the Driving Light Mount Bracket, the lights available to be fitted in the SmartBar will be heavily restricted; and it prevents completely the use of any Light Bar.



# PART NUMBER MATRIX

## SMARTBAR NISSAN NAVARA NP300 04/15-2020

		SmartBar Non Winch	SmartBar Winch	Optional Day Time Running Light
<b>Fitting Times</b>		<b>3 Hours</b>		<b>45 Mins</b>
<b>Non Winch</b>	Model (Guide Only)			
Nissan Navara 4x2 & 4x4	SL, ST, ST-X <sup>1</sup>	SA164BL164		NA <sup>4</sup>
Nissan Navara 4x2 & 4x4	DX, RX <sup>1</sup>	SA169BL164		BP80052
<b>Fitting Times</b>		<b>4 Hours</b>		<b>45 Mins</b>
<b>Winch</b>	Model (Guide Only)			
Nissan Navara 4x2 & 4x4	SL, ST, ST-X <sup>1</sup>		SA164BL165	NA <sup>4</sup>
Nissan Navara 4x2 & 4x4	DX, RX <sup>1</sup>		SA169BL165	BP80052

Please note:

<sup>1</sup> Bar will not suit non-flared models

<sup>2</sup> Bar will only accommodate one option, either Driving or Fog Light. Light kits are supplied with brackets but no loom

<sup>3</sup> Bar accommodates OE Fog Lights

<sup>4</sup> SmartBar for all Navara SL, ST, ST-X models are supplied with DRL as standard