

PRODUCT SPECIFICATIONS

**Date:**

August, 2018

Description:

Land Cruiser 200 SmartBar

Application:

Toyota LandCruiser 200,
10/2015+

Fitting:

Refer Fitment Matrix at back of document

Available:

Now



Product Specification

Toyota have released the second face-lift of the famous 200 Series LandCruiser, which feature a number of changes in the visual appearance of the vehicle. The team at SmartBar have been developing a new frontal protection system styled to suit the 200 Series which is now available.

Designed for the 200 Series Land Cruiser as a partial bumper replacement, the latest model of SmartBar's Vehicle Frontal Protection System (VFPS) perfectly complements the design and shape of the vehicle. The SmartBar maintains all of the factory accessories and all the while providing unparalleled safety.

Designed to suit the GX, GXL, VX and Sahara, the SmartBar is engineered to be the lightest bull bar available; offering even more protection and safety for LandCruiser owners and pedestrians.

Protection & Styling Characteristics:

- Meets full Australian Standard AS 4876.1-2002. Including 3.2 Road User Protection
- Weight savings provide improved fuel economy and reduced tyre, suspension and brake wear when compared to other alternatives
- Fitted Weight of **32kg for Non Winch**
- Fitted Weight of **44kg for Winch**
- Bumper trim, easily fitted
- Superior frontal protection, due to the impact absorbing hollow construction
- Accepts the original vehicle fog lights
- Antenna mount location on loops of the bar, up to 4 available
- High Lift Jack point (Winch Only)
- UV stabilised polymer for durability and corrosion resistance
- Styled to maintain the Vehicle's aesthetics
- Proudly designed and manufactured in Australia
- Minimal maintenance
- Manufactured from environmentally friendly, recyclable polyethylene polymer
- Available in Black
- Compatible with Toyota front parking sensors *(refer to Notes in Part Number Matrix)
- Accommodates a large range of spotlights
- Accommodates up to 12,000lb Winch (please refer overleaf for winch compatibility)
- SmartBar adds approximately 200mm to overall length of the vehicle
- Compatible with ARB Under Vehicle Protection
- Compatible with ARB Recovery Points
- Parking Sensor Kit required for vehicles with parking sensors
- Headlight Washer Kit required for vehicles with headlight washers
- Fog Light Kit available for vehicles without fog lights in the bumper, to fit Fog Lights to SmartBar
- Camera Relocation kit required to be purchased for Sahara model variants that have the Front Camera
- SmartBar is tested to ensure a HIC (Head Injury Criteria) figure below the Australian Standard rating of 1500, as to provide pedestrians with a higher probability of surviving a low speed impact

Chassis Mounts:

The chassis mounts for the LandCruiser 200 series SmartBar are a new design. They're designed to be a single piece bracket and are adjustable in 3 axis to allow perfect and solid fit of the SmartBar every time. The winch and non-winch brackets have been tested and comply with Australian Safety standards.

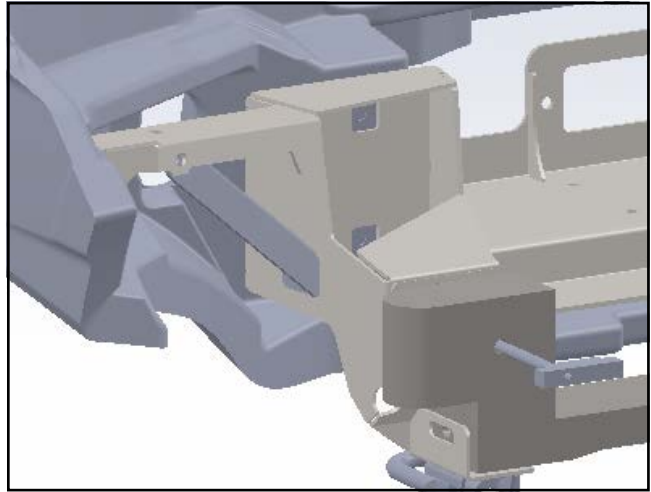

Pedestrian Safety:

SmartBar's have been tested and proven to be less likely to cause serious injury to pedestrians than other alternatives. This is due to the hollow construction which allows the bar to absorb most of the impact along with the unique and specifically designed co-polymer material.



Headlight Washers:

The headlight washers can be relocated from the original bumper into the SmartBar using the optional headlight washer kit SA200HWK.



Parking Sensors:

The SmartBar in both winch and non winch configurations, is fully compatible with the vehicle parking sensors. When parking sensors are to be fitted the SA202BL200 (non winch) or the SA202BL201 (winch compatible) is required.



Fog Lights:

The original LandCruiser fog lights are compatible with the SmartBar. If fog lights are not present in the original bumper the fog light kit SA200FLK can be purchased to fit fog lights to the SmartBar.



High Lift Jack Point:

The SmartBar, in the winch configuration has a Hi-Lift Jack point next to the fair lead area on the drivers side to assist in vehicle recovery.



Antenna Mounts:

There are antenna mounts incorporated onto the top loops of the bull bar. The SmartBar is supplied with a single antenna mount. Additional antenna mounts can be purchased:

Vertical Mount: SAAMB22 (supplied)

Horizontal Mount: TP44928 (optional extra)

Heavy Duty Vertical Mount: SAFMB2 (optional extra)



Driving Light Mounts:

The SmartBar is supplied with an accessory bracket to mount driving lights, light bars and other accessories.

The mount includes pinning holes for the Intensity lights.



Winch Mount:

The SmartBar winch bracket kit is winch compatible for winches up to 12,000lb.



Front Camera:

The front camera on Sahara models can be relocated to the Smartbar with the Front Camera Relocation kit.

Part Number: SA200CRK



Winch Model Fitment:

The SmartBar winch compatible bracket kit accommodates the following winches:

- Warn M8000, XD9000, XP9.5 and XDC 9.5
- Warn ZEON 8, 8-S, 10, 10-S, 12 and 12-S**
- Warn ZEON Platinum 10, 10-S and 12**
- Warn Magnum 10 and 12lb**
- Bushranger DV-9TH, DS9.5TH and Seal 9.5TH

The SmartBar is supplied with an accessory bracket that mounts to the bar in front of the grille. The winch control box can be mounted on the accessory bracket between the spotlights*.

Additional fit kits are required depending on the winch being fitted:

- Warn Zeon and Zeon Platinum fitment requires the Warn Part number W89965 Short wiring kit. This kit allows relocation of the control box to the accessory bracket.
- A flip up number plate bracket is recommended for standard size number plates when SmartBars are fitted with a winch, ARB Part number 3500630.
- Warn ZEON Platinum fitment may require part No. W94288 Enhanced Signal Kit.

*Fitment of the control box to the accessory bracket may restrict the size of the lights that can be mounted. Light bars will not fit on accessory bracket at all in this instance.

**Fitment of Warn Zeon and Magnum requires control box to be relocated to the accessory bracket



Light Model Fitment:

The SmartBar accommodates the following Lights:

ARB Intensity:

- ARB Intensity 21
- ARB Intensity 32
- ARB Intensity AR40*

Bushranger Night Hawk lights:

- NHP180 (S&D) (180mm Round LED light)
- NHS055-NHS245 (5.5 inch)

IPF Lights:

- 801/901 Xtreme Sport Series
- 800/900 HID Series
- 800/900 Series
- 900 Xtreme LED Sport Series
- 868/968 Series
- 930 Super Rally

*If a control box is fitted, this may restrict the lights that will fit in the SmartBar.



PART NUMBER MATRIX



SMARTBAR TOYOTA LANDCRUISER 200 SERIES

Fitting Time	3 Hours	4 Hours	45 Mins	45 Mins	45 Mins	45 Mins
Vehicle	SmartBar non winch ²	SmartBar winch ²	Headlight Washer Kit	Optional Fog Light Kit	Camera Relocation Kit	
Model (Guide Only)			N/A			
LandCruiser 200 Series	SA200BL200	SA200BL201	N/A	SA200FLK ⁷	N/A	N/A
Fitting Time	3 Hr 45 Mins	4 Hr 45 Mins	45 Mins	45 Mins	45 Mins	45 Mins
Vehicle						
Model (Guide Only)						
LandCruiser 200 Series	SA202BL200 ^{3,4}	SA202BL201 ^{3,4}	N/A	SA200FLK ⁷	N/A	N/A
LandCruiser 200 Series	SA202BL200 ^{3,4}	SA202BL201 ^{3,4}	SA200HWK ⁵	N/A	N/A	N/A
LandCruiser 200 Series	SA202BL200 ^{3,4}	SA202BL201 ^{3,4}	SA200HWK ⁵	N/A	N/A	SA200CRK ⁶

Please note:

¹ If Parking Sensors are optioned on the GX and GXL models, the SA202BL200 or SA202BL201 bar is required to be purchased.

² The SmartBar is only available in Black.

³ SA202BL200 & SA202BL201 comes prepared for Parking sensors. They can not be used for vehicles without parking Sensors.

⁴ The Parking Sensor Kit (SA200PSK) is supplied with the SA202BL200 & SA202BL201 SmartBar and does not need to be ordered in addition.

⁵ VX and Sahara model LandCruiser's are supplied standard with Headlight Washers, please note that SA200HWK needs to be ordered when SmartBar will be fitted to these model variants.

⁶ For Sahara models, a Camera Relocation Kit is required to provide the brackets for the relocation of the front camera.

⁷ Fog Light Kit is required for vehicles without fog lights, where a non OEM foglight is to be fitted to the bar.